

THIS DESIGN IS CONFIDENTIAL AND PROPRIETARY OF LDG, INC. NO REUSE OR AUTHORIZED ©2016

**VTSV ADMINISTRATION BUILDING**

CONSTRUCTION DOCUMENTS

1346 NM 150, VILLAGE OF TAOS SKI VALLEY, NM 87525

PROJ. NO: 2018-600  
ISSUE DATE: 10/18/18  
ISSUED FOR:

REVISIONS:		
NO	DATE	DESCRIPTION

DRAFTED BY: LDG  
APPROVED BY: LDG

SCALE: As indicated

**EXISTING/  
DEMOLITION  
ROOF PLAN**

**AD-103**

**DEMOLITION NOTES:**

1. PRIOR TO DEMO, ALL UTILITIES WILL BE SECURED TO PREVENT GAS, ELECTRICAL OR STRUCTURAL SAFETY ISSUES. REVIEW WITH OWNER.
2. CONTRACTOR MUST TAKE ALL NECESSARY PRECAUTIONS TO ENSURE THE SAFETY OF THE PUBLIC AND/OR WORKMEN ON SITE TO PREVENT ACCIDENTS OR INJURY TO ANY PERSON ON, ABOUT OR ADJACENT TO THE PREMISES.
3. THE DEMOLITION PLAN SHALL BE USED AS A SCHEMATIC GUIDE TO DEMOLITION ONLY. ADDITIONAL DEMOLITION MAY BE REQUIRED TO COMPLETE THE WORK AS INDICATED ON THE DRAWINGS. DEMOLITION REQUIRED TO COMPLETE THE PROJECT WORK BUT NOT INDICATED, SHALL BE INCLUDED IN THE CONTRACT SUM. DO NOT ALLOW MATERIALS AND DEBRIS GENERATED BY DEMOLITION ACTIVITIES TO ACCUMULATE ON THE JOB SITE. REMOVE DAILY AND DISPOSE OF IN A LEGAL MANNER, NO ON SITE SALE OR BURNING OF REMOVED ITEMS PERMITTED.
4. DURING THE DEMOLITION OR CONSTRUCTION PHASE, ANY DAMAGE ON THE CONSTRUCTION SITE CAUSED BY THE CONTRACTOR OR A PARTY TO THE CONTRACTOR SHALL BE REPAIRED PRIOR TO CONTRACT DATE OF SUBSTANTIAL COMPLETION AT NO ADDITIONAL EXPENSE TO THE OWNER.
5. CONTRACTOR TO STOCKPILE RE-USABLE MATERIAL AND EQUIPMENT FOR AN INSPECTION BY THE OWNER TO DETERMINE WHAT WILL BE SALVAGED. ALL MATERIAL NOT SALVAGED WILL BE HAULED OFF THE SITE BY THE CONTRACTOR IN APPROVED MANNER AND PER STATE AND LOCAL REGULATIONS.
6. REMOVE, STOCKPILE AND PROTECT ALL FIRE PROTECTION SYSTEM EQUIPMENT FOR RE-INSTALLATION AFTER FINISH SURFACE APPLICATION.
7. CONTRACTOR SHALL COORDINATE SITE ACCESS AND STAGING AREA WITH OWNER AND / OR ARCHITECT.
8. CONTRACTOR TO REMOVE ALL EXISTING FLOORING AND BASE MATERIAL AS REQUIRED WITHIN THE LIMITS OF DEMOLITION AND NEW CONSTRUCTION AS REQUIRED TO ACCOMMODATE NEW FLOORING. PATCH AND PREP AREA OF EXISTING WALL REMOVAL AS REQUIRED FOR NEW FLOORING INSTALLATION.
9. CONTRACTOR TO REMOVE ALL EXISTING CEILING TILES AND GRID WITHIN THE LIMITS OF DEMOLITION AND NEW CONSTRUCTION AND PATCH AND PREPARE AREA OF REMOVAL FOR NEW CEILING INSTALLATION.
10. CONTRACTOR TO REMOVE ALL EXISTING LIGHT FIXTURES, JUNCTION BOXES, WIRING, ETC. WITHIN THE LIMITS OF DEMOLITION AND NEW CONSTRUCTION AND COORDINATE WITH OWNER ON DELIVERY OF SALVAGED EQUIPMENT IF REQUESTED.
11. CONTRACTOR TO REMOVE ALL EXISTING WALL MOUNTED EQUIPMENT AND ACCESSORIES, I.E. SOAP DISPENSERS, PAPER TOWEL DISPENSORS, CLOCKS, SHELVES ETC.
12. REFERENCE ELECTRICAL, MECHANICAL & ELECTRICAL SHEETS FOR ADDITIONAL DEMOLITION.

**KEYED NOTES:**

1. REMOVE EXISTING ROOF OVERHANG STRUCTURE AND SOFFIT AS REQUIRED TO ACCOMMODATE NEW STRUCTURAL MEMBERS FOR NEW OVERHANG.
2. REMOVE EXISTING METAL ROOF, FASCIA, ROOF MOUNTED FIXTURES & EQUIPMENT. INSPECT (E) ROOF DECKING. REPLACE & REPAIR AS NECESSARY. PREPARE FOR INSTALLATION OF OVERFRAMING.
3. DEMO (E) FIREPLACE

**DEMOLITION LEGEND:**

- LIMITS OF WORK
- [ ] DEMO ITEMS: WALLS, PARTITIONS, DOORS, PLUMBING FIXTURES, CASEWORK
- [ ] EXISTING WALL/ PARTITION TO REMAIN
- KEYED NOTE
- [X] EXISTING CONCRETE PATCH; TO BE DEMOLISHED

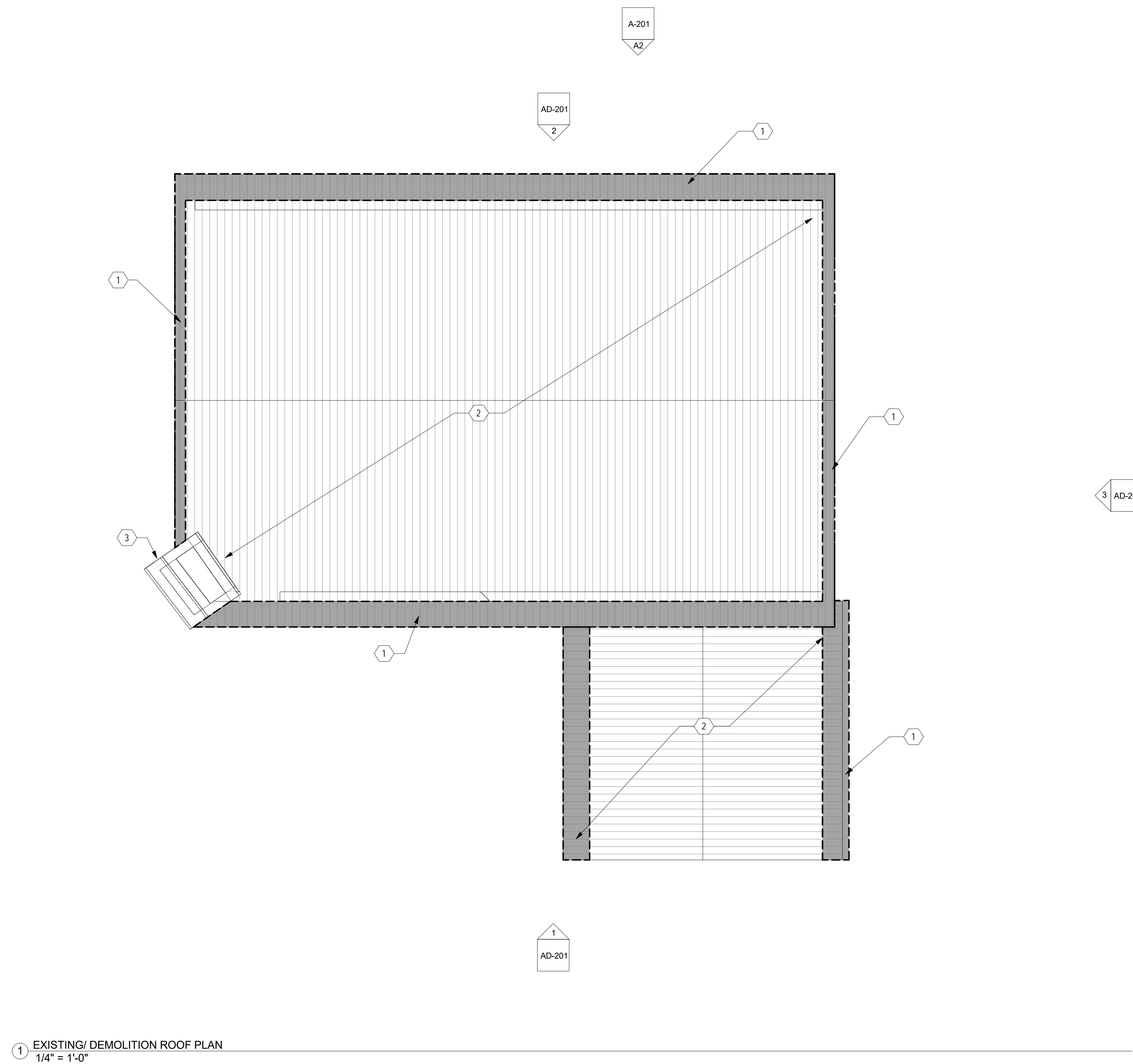

1 EXISTING/ DEMOLITION ROOF PLAN  
1/4" = 1'-0"

Z:\010 ACTIVE PROJECTS\2018-600 VTSV Admin\09 CAD\09\2018-600 - VTSV ADMIN BID SET - JB LOCAL 10.12.18.rvt