

Plotted: 2/22/2021 7:37:06 AM, By: Edingas, Scott
 PLOT: R312498.01 - Twining Road Improvement Project10 CADD & BIM10.1 AutoCADSheet SetXXX SITE
 PLOT: R312498.01 - Twining Road Improvement Project10 CADD & BIM10.1 AutoCADSheet SetXXX SITE
 Last Saved: 2/22/2021 7:27:46 AM, seedings

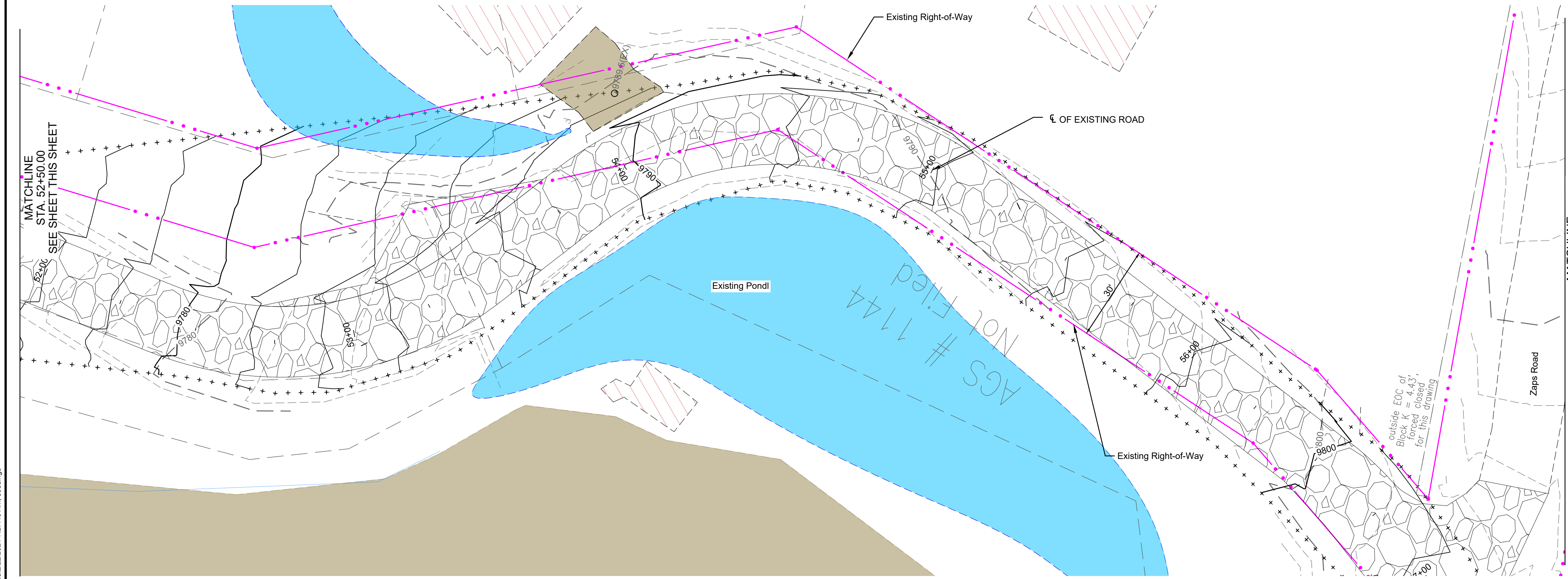

MATCHLINE
 STA. 52+50.00
 SEE SHEET THIS SHEET

MATCHLINE
 STA. 48+00
 SEE PREVIOUS SHEET

PHASE A/B
 EOP

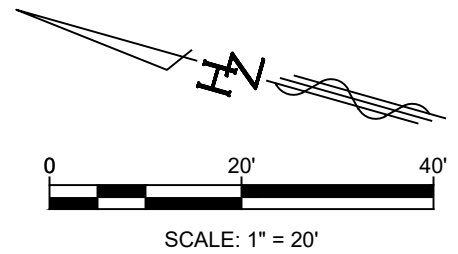

LEGEND

- NEW ASPHALT
- NEW CONCRETE
- NEW SIDEWALK
- NEW AGGREGATE SURFACING
- EX. GRAVEL ROAD
- EX. ASPHALT ROAD
- LIMITS OF DISTURBANCE
- TWINING ROAD RIGHT OF WAY
- PROPERTY LINE

SURVEY INFORMATION		BENCH MARKS		AS BUILT INFORMATION	
NO.	BY	DATE	FOUND MONUMENT	CONTRACTOR	DATE
			STANDARD 3/4" ALUMINUM DISC <td></td> <td></td>		
			NEW MEXICO STATE PLANE COORDINATES (CENTRAL ZONE-N.A.D. 1983) <td></td> <td></td>		
			N=1,47,534.843 <td></td> <td></td>		
			E=1,51,214.742 <td></td> <td></td>		
			ELEV=4865.627 (NAVD. 1988) <td></td> <td></td>		
			GROUND TO GRID FACTOR=0.99885508 <td></td> <td></td>		
			MAPPING ANGLE=-0°14'53.77" <td></td> <td></td>		

ENGINEER'S SEAL
PRELIMINARY
 NOT FOR CONSTRUCTION,
 BIDDING, OR PERMIT PURPOSES.
 FOR REVIEW ONLY.

NO.	DATE	REMARKS	BY

DESIGNED BY: JLM	DATE: February 23, 2021
DRAWN BY: LRT	DATE: February 23, 2021
DWG NAME: XX SITE PLANNING	PROJ #: R312498.01
CHECKED BY: SAE	DATE: February 23, 2021

Designed By:
HUITT-ZOLLARS
 Huitt-Zollars, Inc. Albuquerque
 6501 Americas Pkwy NE, Suite 550
 Albuquerque, New Mexico 87110
 Phone (505) 883-8114 Fax (505) 883-5022

**VILLAGE OF TAOS SKI VALLEY
 TWINING ROAD IMPROVEMENTS**

TITLE:
SITE PLAN
 33+00.00 TO 57+50.00

Design Review Committee	City Engineer	Mo./Day/Yr.	Mo./Day/Yr.
Last Update		Mo./Day/Yr.	Mo./Day/Yr.